

RDT-12K - TELESCOPING POLE, 12 FT



CF-200 - WISPY™  
MULTIPURPOSE WIRELESS  
INSPECTION CAMERA

GOOSENECK

ADAPTER B

ADAPTER A



INSTRUCTIONS FOR MOUNTING JONARD TOOLS [WISPY™](#) TO THE JONARD TOOLS [TELESCOPING POLE](#)

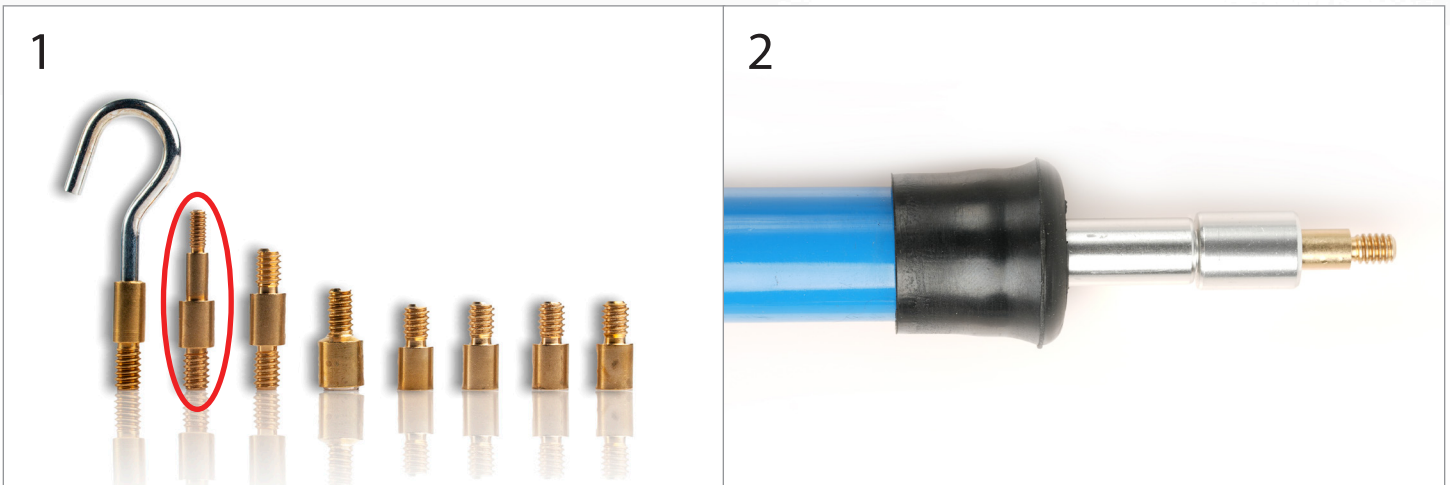

1. Select Adapter B that is provided with the [WISPY™](#)
2. Screw Adapter A into [TELESCOPING POLE](#) then screw Adapter B into Adapter A

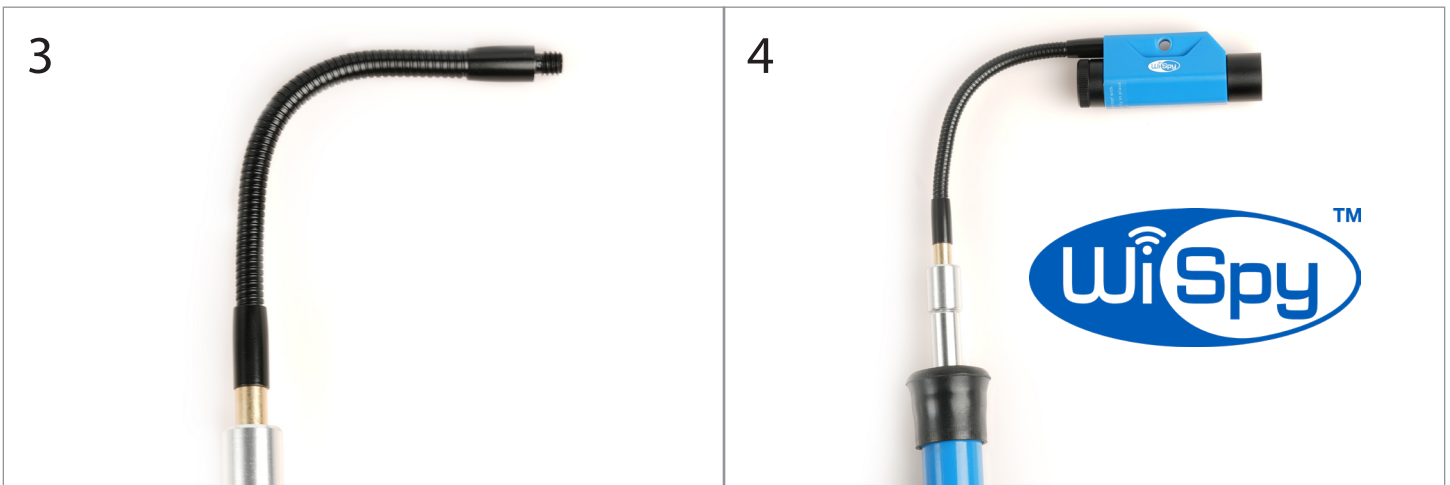

3. Screw the flexible gooseneck rod onto Adapter B
4. Screw the [WISPY™](#) onto the end of the gooseneck as shown above

